

smanos®

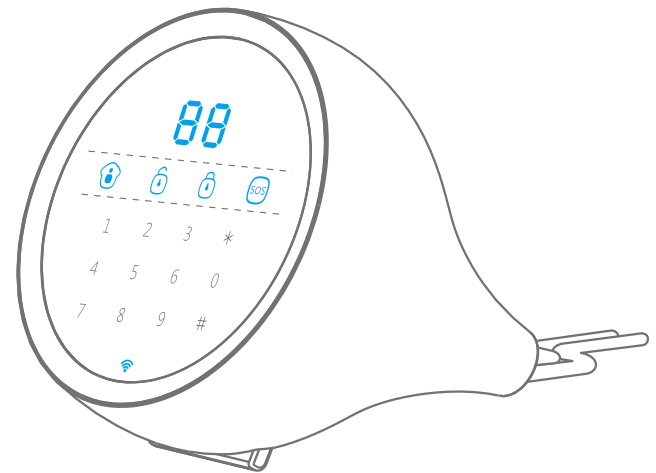

W100 | WiFi/PSTN Alarm System User Manual

Foreword

Congratulations buying this smanos W100 alarm system. Installing the smanos W100 alarm system is easy and quick. Before using the product we recommend reading the manual first. There are some parts of the installation which have to be done in the right order to complete the installation successfully.

Please read this manual carefully before using.

Please keep it properly for future reference.

Please use the product properly.

Features

Powerful

Support entry and exit delay

Support 6 emergency numbers

Expandable up to 30 sensors, 10 remote controls

Built-in battery standby up to 12 hours

High reliability

1,000,000 RF codes combination

110dB siren deterrence

User-oriented

LED screen with disguise keypad

Delete accessories by type

Phone call & smartphone App control anywhere

Table of Contents

Included Accessories	01-02
Overview of Alarm Panel	03-04
Preparation Before Use	04-05
Power On	04
Installation	05
Alarm Panel Operation	06-09
Arm	06
Disarm	06
Home Mode(Part arm)	07
SOS	07
Admin Code	08
User Code	08
Duress Code	09
Restore to Factory Setting	09
APP Operation	10-25
Download Application	10
Connect WiFi to Alarm Panel	11
Disarm, Arm and Home arm	13
History	14
Accessories Setup	14
Wireless Siren Setup	17
Alarm Panel Setup	19
Set Password For App	25
Delete Users	25
Remote Phone Control	26
Test and Install Accessories	27-40
1. Test and Operate the Remote Control	27
Overview	27
Arm(Away Arm)	28
Disarm	28
Home Mode(Part Arm)	29

SOS	29
Mute Operation	30
2. Test and Install the Door/Window Contact	31
Overview	31
Test the Door/Window Contact	32
Install the Door/Window Contact	33
3. Test and Install the PIR Motion Detector	34
Overview	34
Working Mode	35
Test the PIR Motion Detector	36
Install the PIR Motion Detector	37
Installation Notices	39
Add and Delete Accessories	41-46
Connect Accessories to Alarm Panel	41
Connect the Remote Control	41
Connect the Door/Window Contact	42
Connect the PIR Motion Detector	43
Connect the Wireless Siren (Optional)	44
Connect Other Accessories (Optional)	45
Delete Remote Controls	45
Delete Wireless Sensors	45
Delete Wireless Sirens	46
Command List	46
Trouble Shooting	47
Specifications	48-49
Disclaimer	50
Caution and Warnings	51
Terms of Warranty	52
Notes	53

Included Accessories

Please check whether the package contains the following items. If not, please contact the retailer.

W100 Alarm Panel x 1

W100 alarm panel is the "heart and brain" of the whole system, which is for receiving and processing the signals from wireless detectors and remote controls. When the alarm is triggered, the sound can deter intruders on site and there will be send a push message to the application on your smartphone. At the same time the control panel will call the stored emergency phone numbers. After you pick up the phone, you will be able to arm, disarm the control panel and listen through the control panel what is happening on site. You can also setup, arm and disarm the system by application.

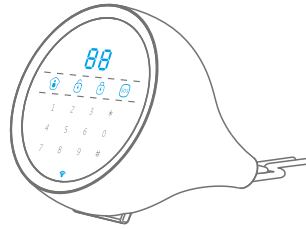

MD2300 PIR Motion Detector x 1

The motion detector uses digital dual-core fuzzy logic control processing technology and an intelligent analysis algorithm. This can prevent false alarm when the signal is being interfered. The motion detector is able to detect the temperature and movement of human bodies within an 8-meter range. When detecting human movement twice in 3 minutes, it switches to the power-saving mode automatically. After 3 minutes of no movement, it switches to the working state.

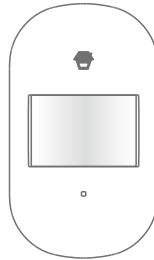

DS2300 Door/Window Contact x 1

The magnet contact can be used for doors, windows, or other devices that can be opened or closed. Once a window or door is opened (the transmitter and magnet are separated), the alarm panel will trigger an alarm.

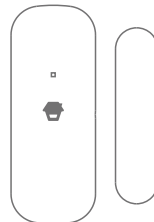

RE2300 Remote Control x 2

With the remote control, you can arm/disarm the system, set home mode, perform mute arm/disarm or make an emergency call.



AC Adapter x 1

The AC adapter provides power to the alarm panel and built-in battery. When the power is off the back-up battery in the control panel will continue to work up to 12 hours.

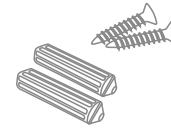
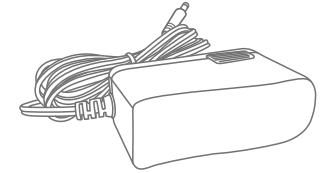

Screw Kit x 1

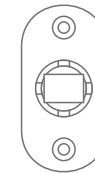

Bracket for
PIR Detector x 1

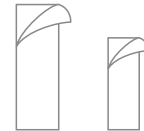

Double-sided Tape x 4
(2pcs for door/window contact
2pcs for PIR sensor)



User Manual x 1



Quick Guide x 1

Overview of Alarm Panel

Front

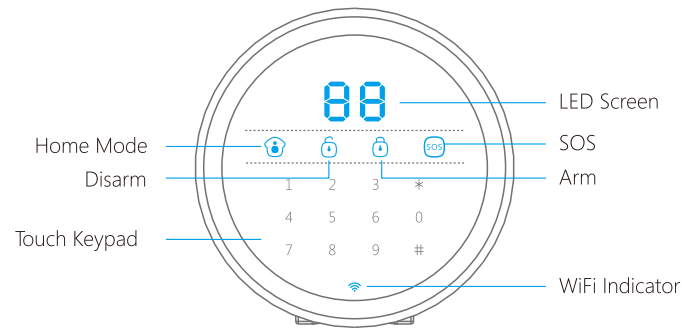

Rear

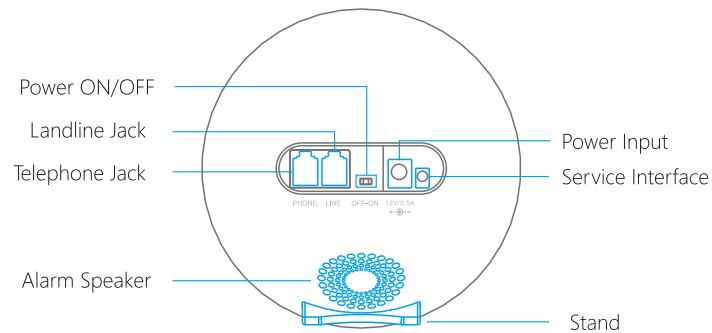

LED Indication

LED	Meaning	LED	Meaning
"00"	SOS	"A"	*
"AP"	In network setup status	"b"	#
"--"	In setting mode	"01"	Zone 1 alarm
"rP"	Tamper alarm	"02"	Zone 2 alarm
"LC"	Line-cut alarm		

Note: The keypad will be blocked and starts flashing once in every 3 seconds in case of low battery.

Preparation Before Use

W100 is a WiFi/PSTN dual network alarm system. Once there is an intrusion, the alarm panel will first send a push message to the application and then call the stored emergency phone numbers by landline. Please make sure the alarm panel has been connected to PSTN land line to ensure safety.

Important: W100 does not support digital telephone network, only support analog telephone network.

- 1 Connect the provided telephone cable to the telephone interface of the alarm panel, the other end to the telephone.
- 2 Connect the landline provided by operator to the landline interface of the W100 control panel.

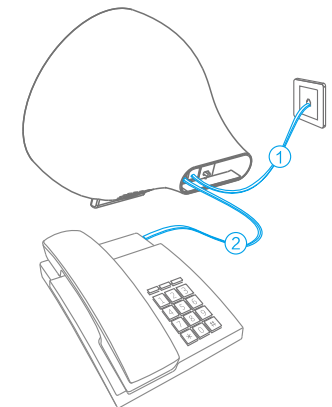

Power On

- ① Plug the output connector of AC adapter into the power jack of the control panel.
- ② Plug the AC adapter to a power outlet.
- ③ Slide the power switch from OFF to ON.

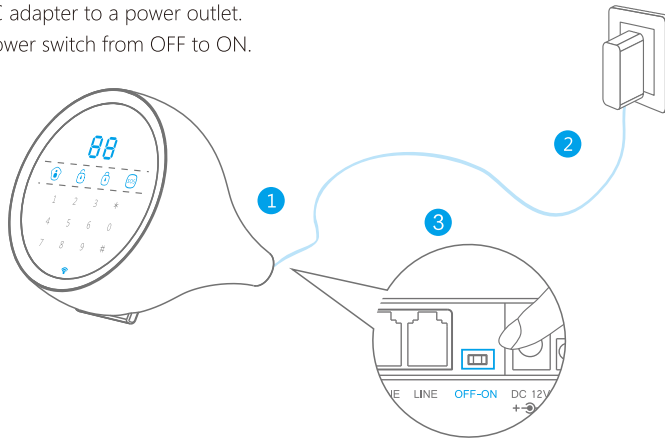

Installation

Put on the table and start to use.

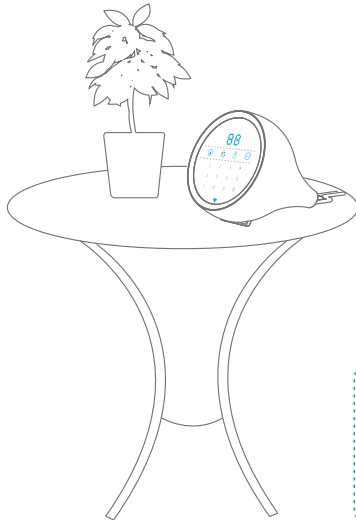

Note: Avoid to use next to a load-bearing wall or home appliances which may cause attenuation. It is recommended to place the control panel in the center of the system or open area for optimal performance.

Alarm Panel Operation

If the passcode lock is turned on, input passcode (admin code or user code) to make the system arm, disarm or in home mode. If the passcode lock is turned off, input passcode only when disarming the system. The passcode lock setting is by default turned off.

Note: See details on how to set the passcode at page 22.

Arm

Press [**Arm**] button, the alarm panel beeps once and LED light turned on. The whole system is in armed status.

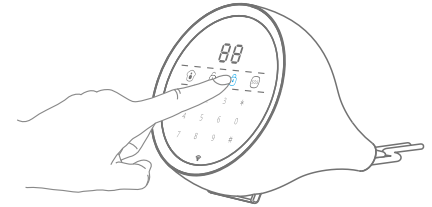

Disarm

Input admin code or user code, then press [**Disarm**] button, the alarm panel beeps once and LED light turned on. The whole system is in disarmed status.

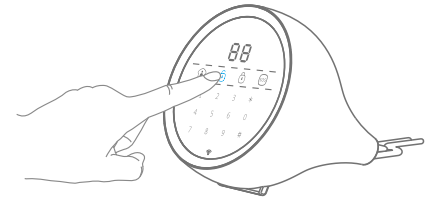

Note: The default admin code and user code are 1234. Three beeps will be heard if the passcode is wrong.

Home Mode (Part Arm)

Press [Home ] button, the alarm panel beeps once and the LED light turned on. The system is in home mode state.

In the home mode, sensors setting to home zone are in disarmed state; other sensors are still in armed state. That is, you can move freely in the home zone; however, the rest areas are still being protected.

Note: The PIR detector is set to home zone by default. That is, the PIR detector will not trigger an alarm after you set the system in home mode.

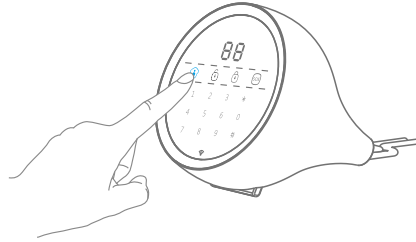

SOS

In case of any emergency, you can press the [SOS] button. Whenever you press the [SOS] button on the alarm panel, the system will alarm immediately. The alarm panel will send push message with the content "Emergency alarm" and then call the pre-stored phone numbers in turn.

Note: No pass code is needed when you press the [SOS] button, no matter the pass code lock is ON or OFF.

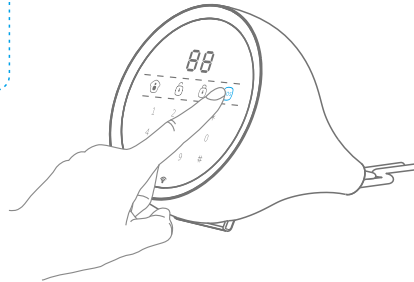

Admin Code

Input admin code, press [#] button, the alarm panel beeps once. When "--" displayed on the LED screen, it means the alarm panel is in setting mode. Input *1* new admin code * to change admin code. Press [Arm ] button to exit setting mode.

Admin code #

1 New admin code *

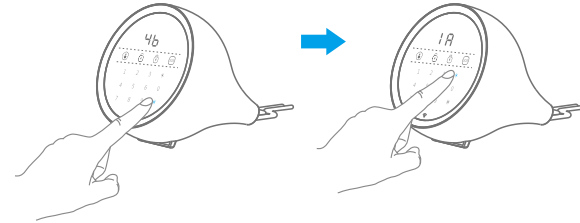

Note: The default setting of admin code is 1234. The admin code is to arm, disarm and setup system settings.
The system exit setting mode automatically when no operation is carried out in one minute.

User Code

Input admin code, press [#] button, the control panel beeps once. When "--" displayed on the LED screen, it means the alarm panel is in setting mode. Input *2* new user code* to change user code. Press [Arm ] button to exit setting mode.

Admin code #

2 New user code*

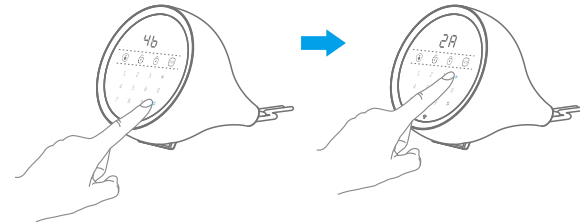

Note: The default setting of user code is 1234. The user code is to arm, disarm and stay in home mode etc.
The system exit setting mode automatically when no operation is carried out in one minute.

Duress Code

When threatened it's possible to disarm the system silently and let the system dial pre-stored phone numbers silently by using the duress code.

Input admin code and press [#], the alarm panel beeps once. When "--" displayed on the LED screen, it means the alarm panel is in setting mode. Input *3* new duress code*. Press [Arm] button to exit setting mode.

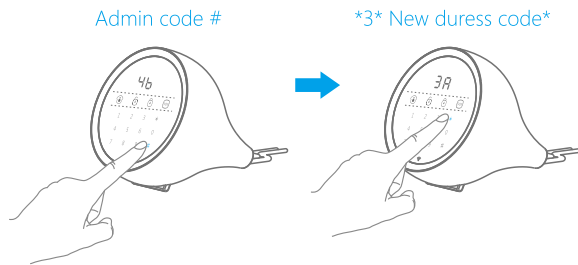

Note: The default setting of duress code is 1111. Admin code, user code and duress code are all consist of 4 digits.

Restore to Factory Setting

Input "*0##" after entered setting mode. All settings except the network and connecting accessories will restore to factory setting. Please reset the pass code for safety.

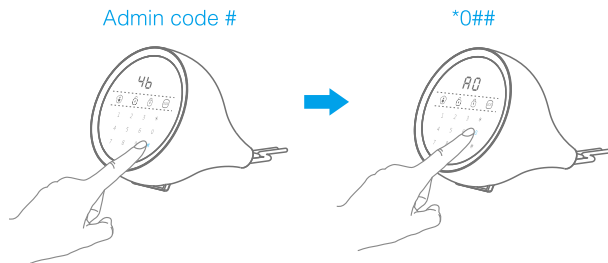

App Operation

Download App

Search keyword "W100 Alarm" in App Store or Google Play. Download and install the App.

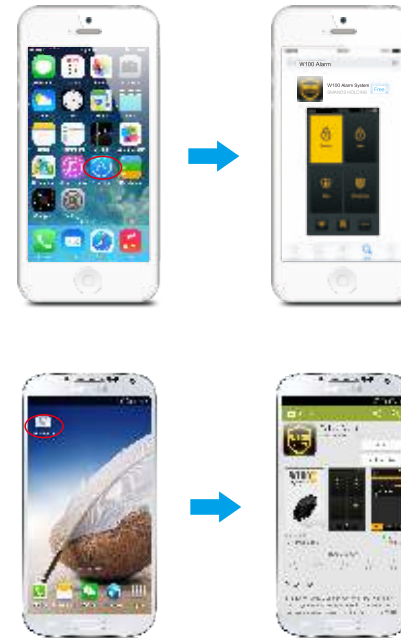

Connect WiFi to Alarm Panel

1. Press [#], enter admin code. Then press and hold [#] again for 3 seconds, the alarm panel beeps once. When "AP" displayed on the LED screen, it means the alarm panel is in WiFi setting mode.

Admin code

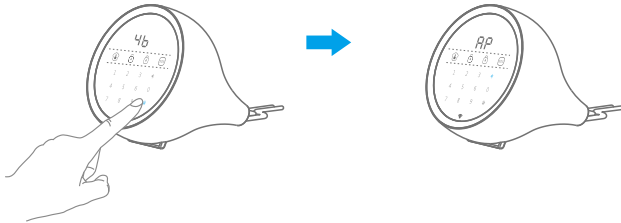

Note: Only connected with the AC adapter can the W100 use WiFi.

2. Access the menu for the WiFi setting on your smart phone, and then choose "W100".



3. The WiFi setup interface appears when firstly enters the App. Input the local network's WiFi name and password, press [Setup WiFi]. One beep is heard from the alarm panel. When [WiFi] icon flashes quickly, means the alarm panel is online. Then, wait until the App enters main interface.



Note: Press[*] to exit "AP" mode.

4. If the local network that connected to the alarm panel is changed, you need to reconnect the alarm panel to a new WiFi network. Tap [WiFi] icon, input new WiFi name and password, then tap [Setup WiFi] icon to reset.



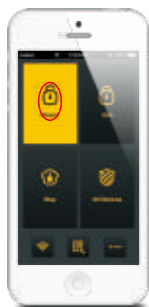

Disarm, Arm and Home Arm

Tap [] icon, the sensors synchronized with alarm panel will be disarmed.

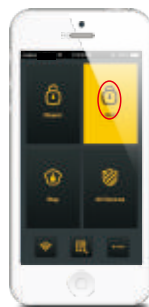

Tap [] icon, the sensors synchronized with alarm panel will be armed.



Tap [] icon, the sensors in home mode zone that is synchronized with alarm panel will be disarmed. Other normal zone sensors synchronized with alarm panel remains in arm state.

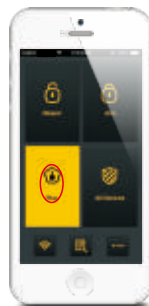

Note: Please refer to page 16 about how to synchronize the alarm panel.

History

Tap [] icon, the latest 20 records of alarm and operation information can be traced.



Note: When the control panel is off line, the time will restore to factory setting.



Accessories Setup

Tap [] to check and edit system settings.



Tap [], all connected sensors displayed.
(See page 43-46 about the connecting way).



 icon in orange means the sensor is synchronized with the alarm panel. Otherwise, it is not.
 icon in orange means the sensor is in arm state.
 icon in orange means the sensor is in disarm state.

Set up the sensors



① Edit sensor name

It is suggested not to exceed 20 characters.



Note: When the alarm panel is alarming, the LED screen will display the number of the triggered sensors. So, in convenience of checking, it is recommended to add relative number before the name of the sensor.
 For instance: 01 Door contact; 02 Living room PIR sensor etc.

② Synchronization

Choose whether to be synchronized with alarm panel or not. If you choose not to synchronize the sensors, the sensors will remain in disarm state no matter if they are in normal zone or home mode zone.

When the sensor synchronized with the alarm panel, the arm/disarm state is as follow:

Accessories	Normal Zone Sensors	Home Mode Zone Sensors
Alarm Panel		
Arm	Arm	Arm
Disarm	Disarm	Disarm
Home Arm	Arm	Disarm



③ Sensor zone

Each sensor can be placed in a zone. Three different zones can be selected. The home zone, normal zone, 24 hour zone. The zone type of the 24 hour zone sensors can't be edited.

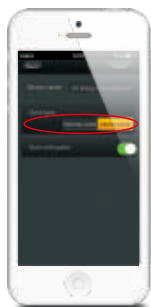

Normal zone sensors: When the alarm panel is in arm or in home mode state, the sensors in normal zone will be in armed state.

Home zone sensors: In home mode, sensors set to home zone are in disarmed state; the other sensors are still in armed state. That is, you can move freely in home zone; however, the rest areas are still being protected. The PIR detector is set to home zone by default. That is, the PIR detector will not trigger an alarm when the system is in home mode state.

24 hour zone sensors: The detector set to 24 hour zone triggers an alarm immediately when detecting intrusion, no matter the system is armed or disarmed. Smoke detector, gas leakage detector, IR beam detector are set to 24 hour zone as default.

Wireless Siren Setup

Tap [Sirens ] to enter the siren setting menu.



Slide the switch to turn on/off the siren.

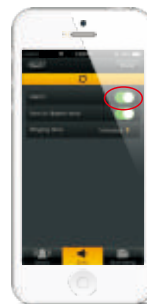

Slide the switch to turn on/off the arm/disarm tone.

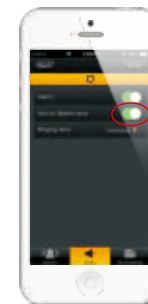

Edit the ring time from 0~9 minutes. After all settings finished, tap [Done]. The default setting is 1min.



Alarm Panel Setup

Tap [Panel Settings >] and enter the alarm panel setup menu.



Internal Siren Volume

Tap [Volume] to choose the alarm volume level: mute, low and high. The default setting is high.

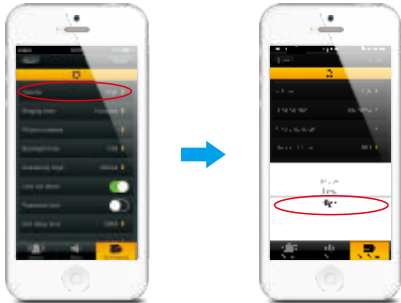

Ringing Time

Tap [Ringing time] to set internal siren alarming duration from 1 to 9 minutes. Default setting is 1 min.

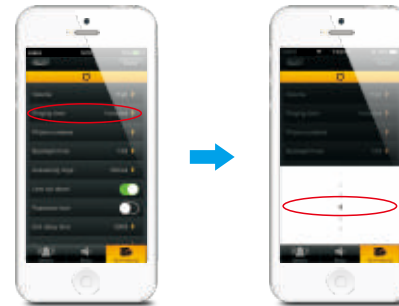

Store Phone Numbers

Tap [Phone numbers] to enter the interface for alarm phone number storage, 6 emergency phone numbers can be stored. When the system is triggered, it will send push message through WiFi network and make call to the pre-stored alarm phone numbers. If the control panel is connected with an extension phone, please add 9# or 0# before the stored phone number.



Note: If the WiFi network is disconnected, the alarm panel will only dial the phone number instead of sending push message.

Backlight Time

Tap [Backlight time] to set the lighting time period from 0 to 99 seconds. Default setting is 10 seconds.

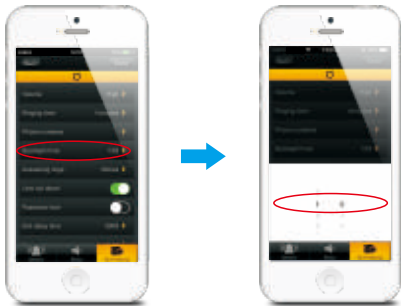

Line-Cut Alarm

Slide the switch to turn on/off the line cut alarm function. Line-cut alarm means whenever the telephone line is cut off, the system will alarm immediately.

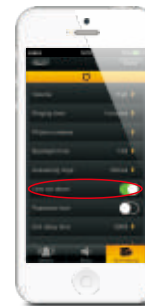

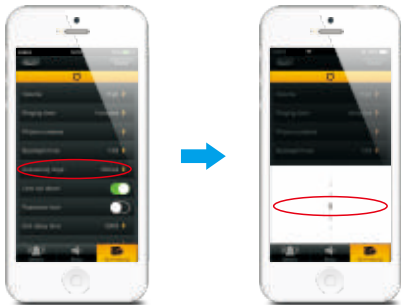

Answering Rings

Tap [Answering rings] to set the ringing times from 0 to 9. "0" means to turn off the remote phone control. Call the phone numbers of the control panel, the control panel will enter remote phone control automatically after the set answering rings if the remote phone control was enabled.



Note: The remote phone control is turned off by default.

Passcode Lock

This function is to prevent users operating by mistake. Slide the switch to turn on/off the password lock. If the function is on, users need to input the admin code or user code before pressing [Arm , [Disarm , or [Home Mode ] on the alarm panel.

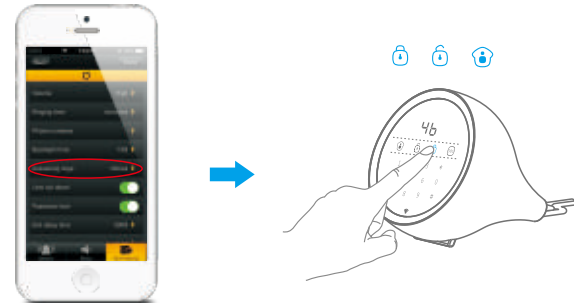

Exit Delay Time

Tap [\[Exit delay time\]](#) to set the delay time from 0 to 299 seconds for arming when exit home.

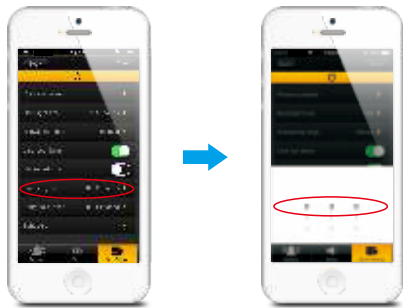

Entry Delay Time

Tap [\[Entry delay time\]](#) to set the delay time from 0 to 299 seconds for alarming when enter home.

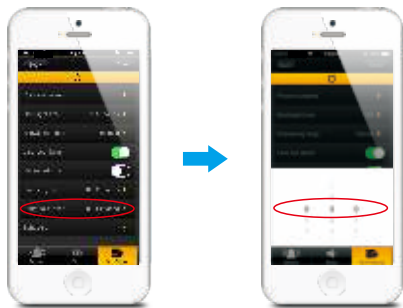

Note: If users don't want to carry along remote controls, they can set the entry or exit delay. Suppose entry delay was set at 30 seconds, the system will allow users 30 seconds to disarm the system before alarming. Suppose exit delay was set at 35 seconds, the system will allow users 35 seconds to leave before the system is armed. The 'beep' is heard every second to remind users to leave. The pace of reminding will speed up in last 7 seconds. Thus leaves the user enough time to leave the home without triggering the system.

Schedule

Tap [\[Schedule\]](#) to set the timing arm/disarm function. Time and repeat mode can be editable. Slide the switch to turn on/off the timing function. Tap [\[Done\]](#) to save the setting. 3 timing groups are available.



Note: Please store the information after setup by tap "Done".

Set Password For App

Tap [•••] – [Set password] to set whether to turn on/off the operation code for App.

When it is turned on, users can only login the operation interface by inputting the correct code.



Note: It is recommended to set the App code for your safety.
Any App that completed the network connection with the alarm panel will receive the push message when alarming, if you don't want to receive it, please unload the App.

Delete Users

Tap [•••] – [Delete users], input password of your local WiFi, then tap [Done]. All other users will be deleted.



Note: Please make sure the mobile phone and alarm panel is in a different network when deleting users.

Remote Phone Control

Make sure the function of remote phone control is turned on. Any phone number can get access to the alarm system by dialing the telephone number of the alarm panel. After the pre-set answering rings, one beep is heard, input admin code or user code, and then press [#]. After another beep, the system enters remote phone control status. Operate the system by following the command instruction.

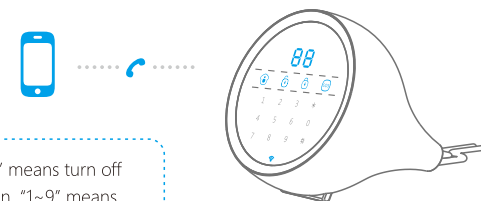

When set the answering rings, "0" means turn off the remote phone control function. "1~9" means turn on the remote phone control function (See page 21 to set answering rings). After receiving the alarm call, user can operate the system by enter the following command no matter whether the remote phone control is enabled or not.

Command Instruction

Function	Command	Status after the operation
Disarm the system	0	System disarmed after two beeps
Arm the system	1	System armed after one beep
Turn on siren	9	Siren turned on after one beep
Turn off siren	6	Siren turned off after one beep
Monitor on site	*	Monitor on site for 60 seconds after one beep. Press [*] to extend
To exit remote phone control	#	Beep twice, it will exit the remote control and hang up

Note: Alarm system will hang up after 30 seconds without operation.

Test and Install Accessories

Accessories in this kit can work only with its own control panels.

1. Test and Operate the Remote Control

RE2300 remote control is delicate and easy to carry. It can be attached to your key ring, or just put into your pockets or purses. When you are about to exit or entry the house, you can use it to arm or disarm the system. In case of any emergency, just press the [SOS] button, the alarm will be activated immediately.

Overview

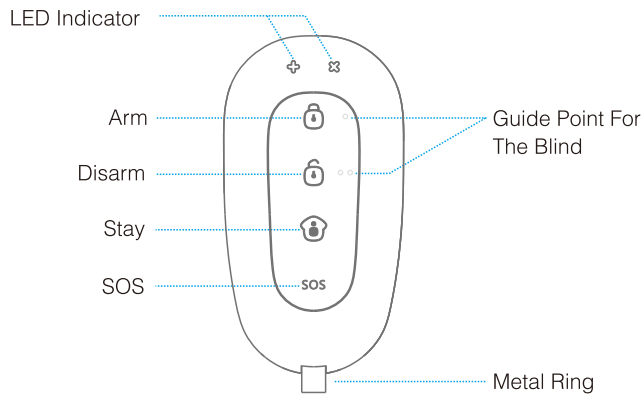

LED indication

- + LED flashes once: Armed or in home mode
- × LED flashes once: Disarmed
- +, × LEDs flashes once: SOS

Arm (Away Arm)

Press the [Arm] button. The control panel beeps once and the mode LED is on, indicating the system is in armed state.

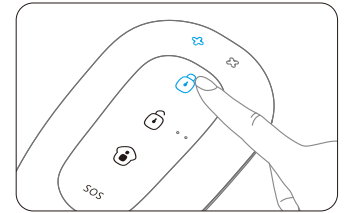

Note: If you do not want to take the remote control, exit delay can be set. For related definition and setting, please refer to page 23.
If a wireless keypad is used, you only need to enter the password on the keypad without using the remote control.

Disarm

In disarm state, the detectors (except those accessories in the 24 hour zone) will not trigger an alarm when detecting intrusion.

Press the [Disarm] button. The control panel beeps twice and the mode LED is off, indicating the system is in disarmed state.

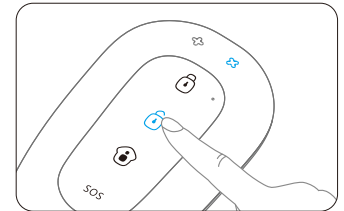

Note: If entry delay is set, you can enter your home directly in the armed state, then disarm the system within the delay time. No alarm will be triggered in this case. If you disarm the system after the delay time, the system will trigger an alarm.

Home Mode (Part Arm)

In home mode, detectors setting to home zone are in disarm state; the other detectors are still in arm state. That is, you can move freely in the home zone; however, the rest areas are still being protected.

Press the **[Stay]** button. 3 seconds later, the control panel beeps once and the mode LED is on.

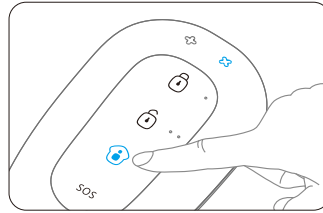

Note: The PIR detector is set to home zone by default. That is, the PIR detector will not trigger an alarm after you press the **[Stay]** button.

SOS

In case of emergency, you can press the **[SOS]** button.

Whenever you press the **[SOS]** button on the remote control, the system will alarm immediately and send push message, then call the pre-stored phone numbers.

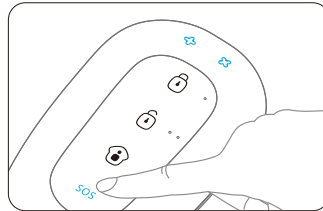

Mute Operation

You can arm and disarm the system silently.

Press the **[Stay]** button for 1 second, and then press the **[Arm]** button within 3 seconds. The system is armed silently.

Press the **[Stay]** button for 1 second, and then press the **[Disarm]** button within 3 seconds. The system is disarmed silently.

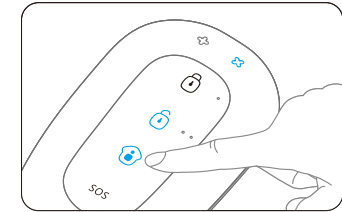
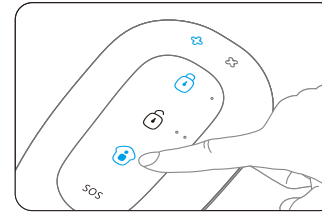

Note: If wireless strobe sirens are used, they will not sound either.

2. Test and Install the Door/Window Contact

The contact contains a transmitter and a magnet, which can be mounted on a door, window, or any object that can be opened or closed. When the transmitter and magnet are separated, the contact will send a signal to the control panel and the control panel will trigger an alarm. The tamper switch ensures that sabotage attempts to disassemble the contact will trigger an alarm.

Overview

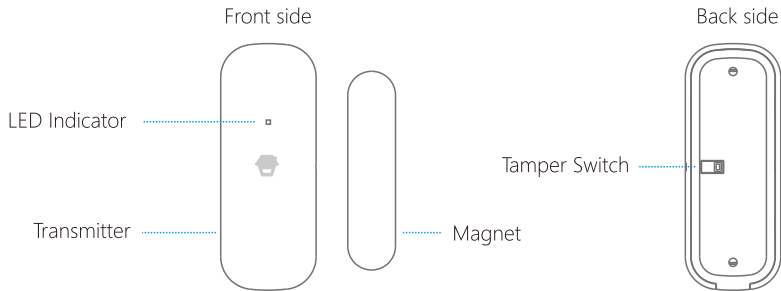

LED Indication

Flash once: Intruder is detected.

Flash once per 3 seconds after triggered: Low battery. Replace the battery as soon as possible.

PCB Layout

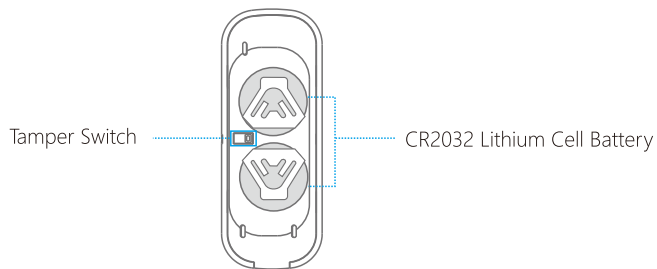

Note: When tamper switch is pressed, system will alarm immediately.

Test the Door/Window Contact

This is to test whether the contact can work properly.

1. Remove the insulating strip

The contact works immediately.

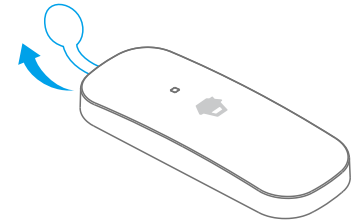

2. Pay attention to the direction

There are triangle marks on the side of the transmitter and magnet. Make sure the triangle marks are close to each other and within the range of 1 cm.

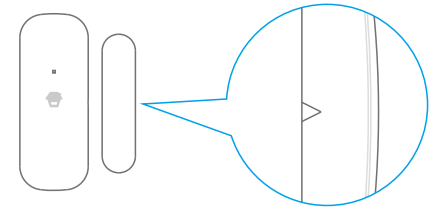

3. Test the door/window contact

Press the **[Arm]** button. The system switches to the arm state. Separate the transmitter and magnet with the space more than 2 cm. The red LED on the transmitter is on. Then, the control panel triggers an alarm. This means the contact works properly.

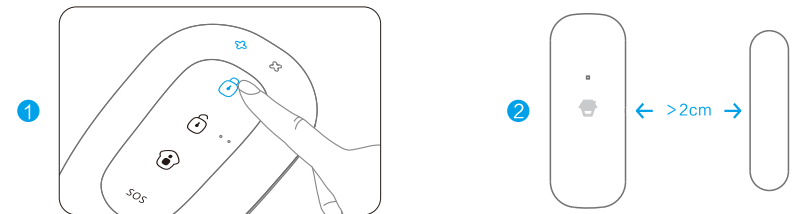

Install the Door/Window Contact

Make sure the contact works properly before installing it. There are triangle marks on the side of the transmitter and magnet. Make sure the triangle marks is close to each other and within the range of 1 cm. As long as the space between the transmitter and magnet is over 2 cm and the LED on the transmitter is on.

Secure the contact with double-sided tapes

Secure the transmitter and magnet on the desired locations with double-sided tapes.

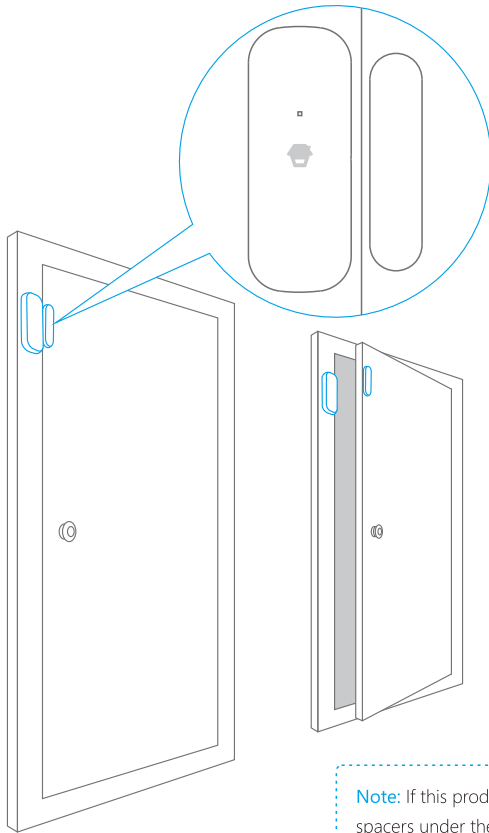

Note: If this product is installed on metal door, place spacers under the transmitter and magnet.
This product is not suitable for shutter door, please purchase shutter door sensor for your use.

3. Test and Install the PIR Motion Detector

The detector adopts digital dual-core fuzzy logic control processing technology and intelligent analysis algorithm, effective resolution of interfering signal and human movement signal, preventing false alarm. It features automatic temperature compensation and resistance to flow technology, adapting to environmental and temperature change. It can detect human movement within the 8-meter cone space, suitable for halls, hallways, etc.

Overview

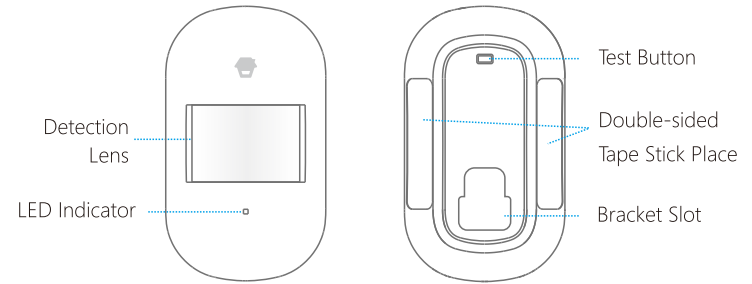

LED Indication

Flash continuously: Self-testing.

Flash once: Intrusion is detected.

Flash twice: 3 minutes testing mode is finished, enters power saving mode.

Flash once per 3 seconds: Low battery indication, please change the batteries immediately.

PCB Layout

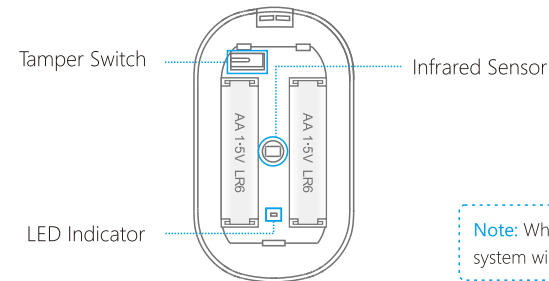

Note: When tamper switch is triggered, system will enter alarm state.

Working Mode

Testing Mode

After self-testing, press the test button, the detector switches to the testing mode and detects once every 10 seconds. It triggers an alarm. After 3 minutes, the LED flashes twice, and the detector switches to the power saving mode.

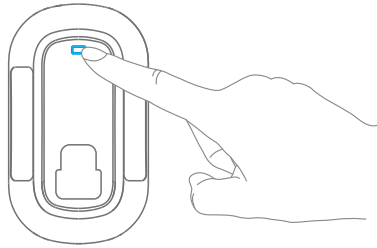

Power Saving Mode

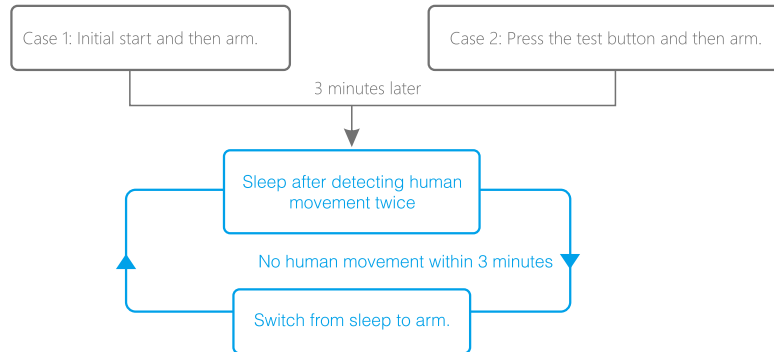

The product features power-saving design. If the detector detects human movement twice in 3 minutes, it will switch to the sleeping state to save power. At this time, the LED will not flash and no alarm. After no movement within the next 3 minutes, the detector switches back to the working state automatically.

Note: After the detector is in the sleeping state, ensure no human movement within 3 minutes; otherwise, the detector remains sleeping. In the sleeping state, it is recommended that you leave the room after arming the system. Ensure no human movement in 3 minutes. Then, go into the room, the system alarms immediately.

Test the PIR Motion Detector

This is to test whether the PIR detector works normally.

1. Remove the insulating strip

Remove the insulating strip.

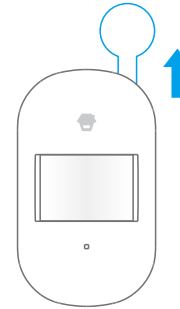

2. Arm the system

Press the [Arm] button on the remote control. The system is armed.

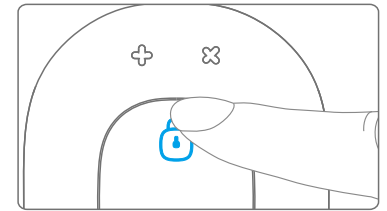

3. Trigger an alarm

Keep pressing the test button at the back until the control panel sounds. It indicates that the PIR motion detector is connected to the control panel.

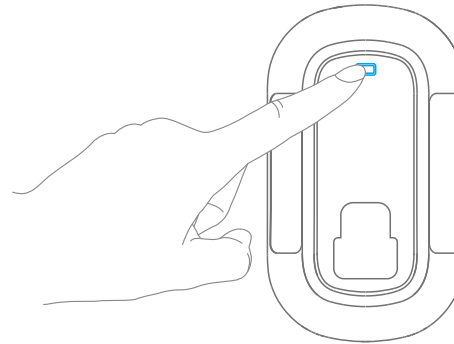

Install the PIR Motion Detector

After making sure the detector works normally, do as follows:

1. Choose a suitable installation location

For installation notices, please see page 39-40.

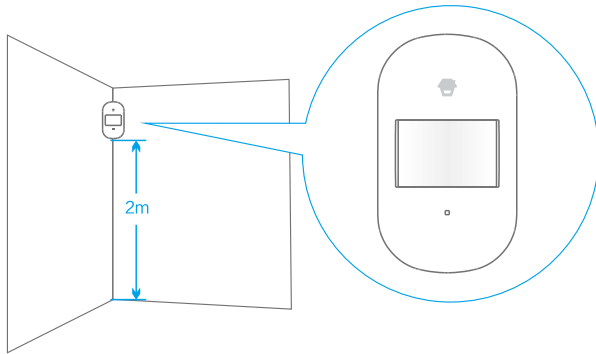

2. Fix the detector

Fix the installation bracket on the wall with screws, and then fit the groove at the back of the detector on the bracket. For the detector of this model, you can stick it at the corner with double-sided tapes.

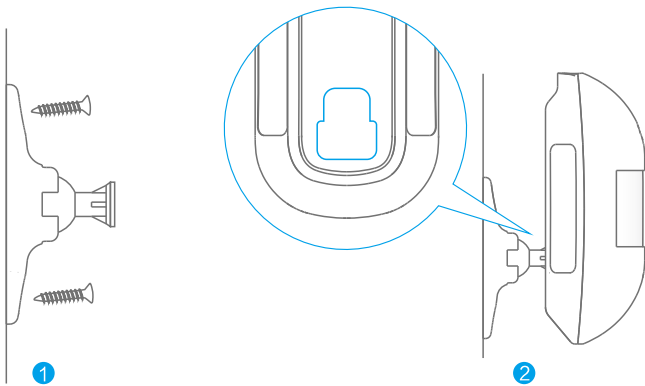

3. Test the PIR motion detector

Press the test button at the back. It switches to the testing mode and sustains for 3 minutes. Walk in the detection scope and observe the LED. When human movement is detected, the LED flashes once.

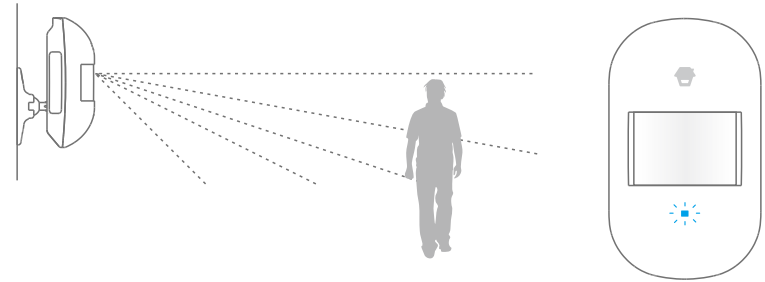

4. Adjust the angle

Adjust the bracket angle to achieve the best detection effect.



Installation Notices

Pay attention to the following during installation:

1. Mount the detector to a location close to the entry or exit

It is recommended to mount it at the height of 2m from the ground. The detector aims at preventing intrusion. Detecting human movement at the entry or exit is critical for security.

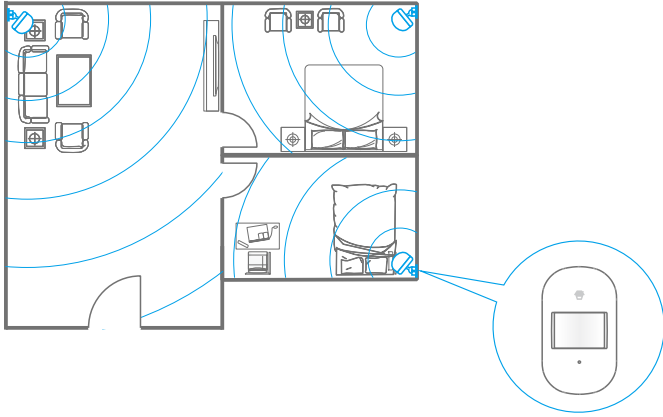

2. Mount the detector in a proper angle

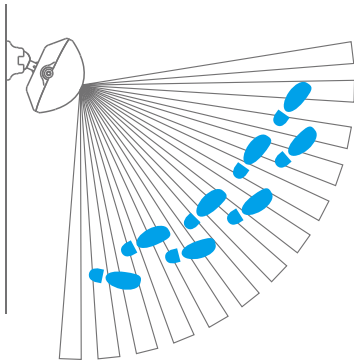

The installation angle affects sensitivity directly. The sensitivity is optimal when the walk direction is vertical to the infrared direction. Choose the best location and angle according to the actual situation and detection scope diagram.

3. Avoid facing to glass windows or doors

Strong light interferes with detection sensitivity. In addition, complicated situations, such as traffic flow, stream of people, also should be avoided.

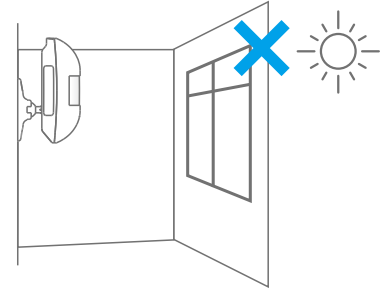

4. Avoid facing to or positioning close to heat/cold sources

Heat/cold sources, such as heat extraction units, heaters, air conditioner, microwave oven, refrigerator, which may cause false triggering, should be avoided.

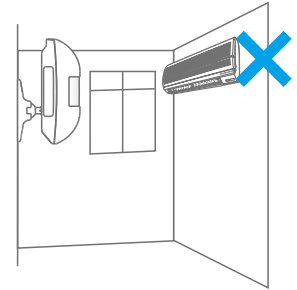

5. Avoid facing to swinging objects

Swinging objects may also trigger false triggering. Besides, if there are two detectors covering the same scope, adjust the locations to prevent cross-interference.

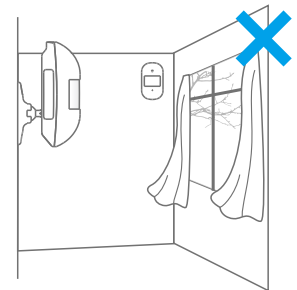

Add and Delete Accessories

Connect Accessories to Alarm Panel

Accessories need to be connected to the alarm panel so that the alarm panel can receive signals from them and sound the alarm. Accessories in the kit have been connected to the alarm panel before delivery, and ready for use. If the control panel does not trigger alarms, reconnect them. Accessories purchased separately must be connected to the alarm panel before use.

Under connecting mode, the LED screen shows the number of sensors connecting. For instance, when the LED screen shows 5, which indicates 4 sensors has connected successfully.

Connect the Remote Control

1. The panel enters connect mode

Input admin code, press [#], the alarm panel beeps once to enter setting mode. Then press #0*, the alarm panel enters connect mode.

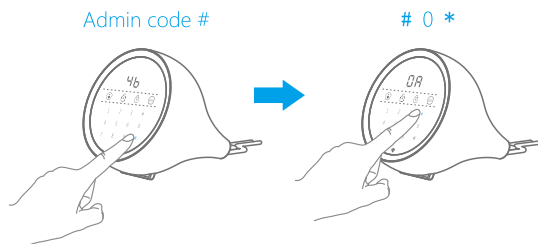

Note: Press [Arm] , [Disarm] or [Home] to exit connect mode. If no operation within 30 seconds, the alarm panel will beep once to exit connect mode.

2. Press any key on remote control

Press any key on the remote control, the alarm panel beeps once. Connection is successful.

Note: Once two beeps are heard, it indicates the accessory has been connected already.

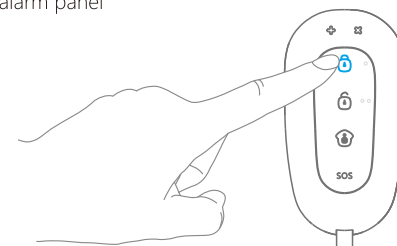

Connect the Door/Window Contact

1. The panel enters connect mode

Input admin code, press [#], the panel beeps once to enter setting mode. Then input #**, the alarm panel enters connect mode.

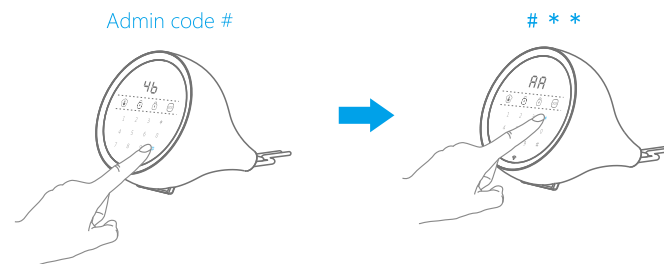

2. Separate the magnet and transmitter

Separate the magnet and transmitter with the space more than 2cm, the alarm panel beeps once, indicating successful connection.

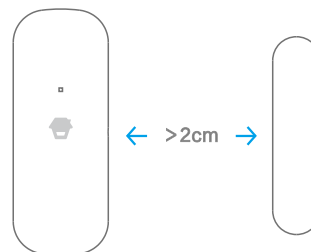

Note: Once two beeps are heard, it indicates the accessory has been connected already. Please don't trigger the tamper switch when connecting. Otherwise, the system will recognize the sensor as 24 hour zone. Please delete and reconnect if this happens.

Connect the PIR Motion Detector

1. The alarm panel enters connect mode

Input admin code, press [**#**], the alarm panel beeps once to enter setting mode. Then press ******, the alarm panel enters connecting mode.

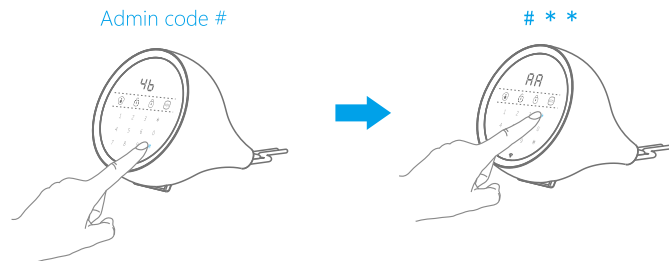

2. Press the testing button on the PIR motion detector

Press the testing button twice at the back of the PIR motion detector. The alarm panel beeps once, indicating the connection is successful.

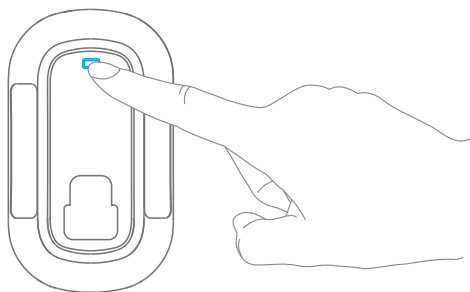

Note: If the alarm panel beeps twice, it indicates the detector has been connected before.

Connect the Wireless Siren (optional)

1. Make sure the wireless siren enters connect mode

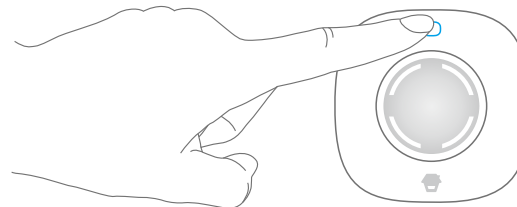

2. Press [**Arm**] on the alarm panel

Press the [**Arm**] on the alarm panel, the siren beeps once which indicates successful connection.

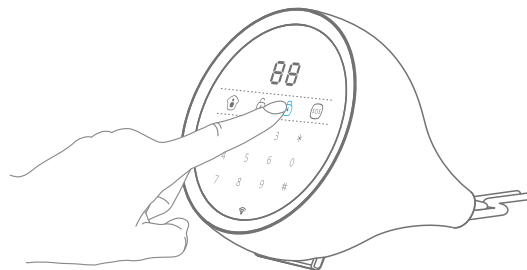

Note: If the siren beeps twice, it indicated the wireless siren has been connected before. To connect other wireless siren, please refer to the related manuals.

Connect Other Accessories (optional)

For how to connect other accessories to the alarm panel, please refer to related manuals.

Delete Remote Controls

Input admin code, press [#], the alarm panel beeps once to enter setting mode. Then press #0#, one long beep is heard, all the remote controls is deleted.

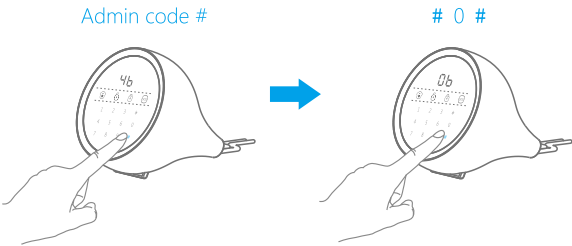

Delete Wireless Sensors

Input admin code, press [#], the alarm panel beeps once to enter setting mode. Then press #*#, all the wireless sensors are deleted.

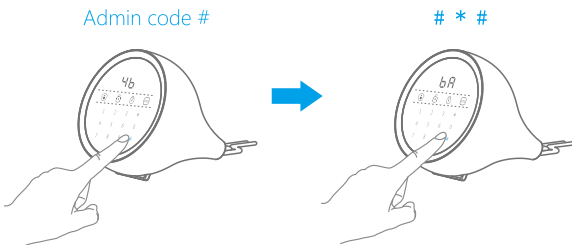

Delete Wireless Sirens

Delete wireless siren is to delete the connection to alarm panel. Press and hold the connect button on the wireless siren until one beep is heard, it indicate the connection is deleted successfully.

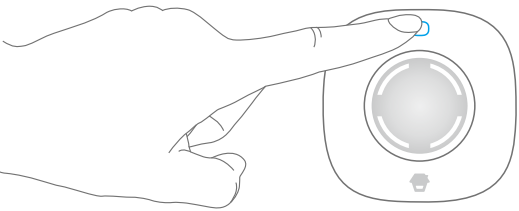

Command List

Functions	Command
Change admin code	*1*new admin code*
Change user code	*2*new user code*
Change duress code	*3*new duress code*
Enter setting mode	Admin code#
Connect remote control	#0*
Delete remote control	#0#
Connect wireless sensors	#**
Delete wireless sensors	#*#
Restore to factory settings	*0##

Trouble Shooting

Questions	Cause/Trouble Shooting
The App can't get in the main interface when setup WiFi	Please check the local WiFi
App show "Return data timeout"	Please check the local network or cellular network
The alarm panel beeps three times	Wrong operation
The touch keypad flashes once per 3 seconds	The alarm panel is in low voltage, please connect the AC power ASAP
Remote control don't work	The remote control is disconnected from the alarm panel
	The distance is beyond the operation range
Door contact don't work	The door contact is disconnected from the alarm panel
	The distance is beyond the operation distance
Detector don't work	Check whether the detector had paired with panel successfully
	The detector is too far away from the panel
	Check whether the detector is in sleeping state Learn about the mode and requirements of install location
Alarm panel has no sound	Check if the internal siren volume is set to mute
No phone call when alarming	Please check if the alarm panel is connected to landline
Remote phone control don't work	Please check if the remote phone control is turned on
The alarm panel can't find network	Check if the local network is the same with the WiFi when setup
No push notification	Please check if the local or cellular network works properly
Admin code is missing	Please contact the local retailer for help

Specifications

W100 Alarm Panel

Power Supply	DC 12V 500mA
Backup Battery	3.7V 1200mAh 18650 rechargeable lithium battery
Static Current	≤ 100mA
Alarm Current	≤ 250mA
Internal Siren Volume	110 dB
Supported Accessories	10 remote controls, 30 sensors
Radio Frequency	868/915 MHz
Housing Material	ABS+Acrylic
Operating Condition	Temperature: -10°C ~+ 55°C Relative Humidity: ≤ 80% (non-condensing)
Dimensions	138.8 x 125 x 125.5 mm (L x W x H)

RE2300 Remote Control

Power Supply	DC 3V (CR2032 lithium cell battery x 1)
Transmit Current	≤ 9.5 mA
Transmitting Distance	≤ 80 m (open area/no interference)
Radio Frequency	868/915 MHz
Housing Material	PC+ABS plastic
Operating Condition	Temperature: -10°C ~+ 55°C Relative humidity: ≤ 80% (non-condensing)
Dimensions	71 x 38 x 12 mm (L x W x H)

DS2300 Door/Window Contact

Power Supply	DC 3V (CR2032 lithium cell battery x 2)
Static Current	≤ 1 uA
Alarm Current	≤ 10.5 mA
Transmitting Distance	≤ 80 m (open area/no interference)
Radio Frequency	868/915 MHz
Housing Material	ABS plastic
Operating Condition	Temperature: -10°C ~+ 55°C Relative humidity: ≤ 80% (non-condensing)
Transmitter Dimensions	72.5 x 28 x 10 mm (L x W x H)
Magnet Dimensions	58 x 14 x 9.5 mm (L x W x H)

MD2300 PIR Motion Detector

Power Supply	DC 3V (1.5V AA battery x 2)
Static Current	≤ 50 uA
Alarm Current	≤ 11 mA
Detection Scope	8m/110°
Transmitting Distance	≤ 80 m (open area/no interference)
Radio Frequency	868/915 MHz
Housing Material	ABS plastic
Operating Condition	Temperature: -10°C ~+ 55°C Relative humidity: ≤ 80% (non-condensing)
Detector Dimensions	101.5 x 59 x 37.5 mm (L x W x H)
Bracket Dimensions	60 x 29 x 27 mm (L x W x H)

Disclaimer

smanos have reviewed this manual thoroughly in order to make it an easy to use guide for this product. All statements, technical information, recommendations in this manual are believed reliable, but the accuracy and completeness are not guaranteed or warranted.

The specifications and information regarding the products in this document are subject to change without notice.

Photocopy, copy, reproduction, translation to any language, modification, storage in a retrieval system or retransmission, in any form or by any means, electronic, mechanical or otherwise, is strictly prohibited without prior written permission.

In no event shall smanos be liable for any indirect, special, incidental, or consequential damages, including, without limitation, lost profits or loss or damage to data arising out of the use or inability to use this document, even if smanos has been advised of the possibility of such damages.

Caution and Warnings

Due to laws and regulations determined by the European Parliament, some (wireless) devices may be subject to restrictions on its use in certain European countries. In some EU Member States, the use of equipment are prohibited. Contact your (local) government for more information on these restrictions.

Always follow the instructions in the manual, especially when it concerns devices which need to be assembled.

Warning: in most cases it is an electronic device. Incorrect or improper uses of the device may result in (serious) injuries.

Repairing the unit must be done by smanos qualified personnel. The warranty expires immediately if the unit is repaired and/or when the product is misused.

Terms of Warranty

The three-year warranty applies to all smanos products unless otherwise specified at the time of purchase. When buying a second hand smanos product the product warranty remains measured from the time it was bought by the original owner. Power supplies, batteries, antennas and all other products integrated in or directly connected with the main product or products that may reasonably assumed to have a different wear pattern than the main product are therefore not covered by the smanos guarantee. The warranty doesn't apply when incorrect or improper use, external influences and/or opening of the housing has been done by parties other than smanos.

SMANOS HOLDING LTD
Jacobus Spijkerdreef 386
2132 PZ Hoofddorp
The Netherlands
www.smanos.com

Notes

Sensor	Sensor type	Name	Group		
			Normal	Home	24/7
Zone 1	Magnet contact				
Zone 2	Motion detector				
Zone 3					
Zone 4					
Zone 5					
Zone 6					
Zone 7					
Zone 8					
Zone 9					
Zone 10					
Zone 11					
Zone 12					
Zone 13					
Zone 14					
Zone 15					
Zone 16					

CHUANGO®			
产品型号	W100	部件名称	说明书
设 计	林寿	材 料	80克书写纸
印刷尺寸	258x185mm	成品尺寸	129x185mm
工 艺	装订方式 胶粘	版 本	OI: W100-UM-EN-V1.0
注： 双面四色印刷60P			